



**OSTEQ lifetime warranty.**

OSTEQ hand tools are manufactured to be free of defects in materials or workmanship, and it will be warranted for lifetime of the tools.

In case of defects in material or workmanship, it can be claimed at OSTEQ distributor or at the store of purchase and it will be repaired or replaced for free of cost.

Note : Normal worn out from used, misuse, abused, modified, over torque application, carrying cases, pouches, bits, parts or others consumable items are not covered by this Warranty.



USA

COMBINATION WRENCHS  
AND ADJUSTABLE  
WRENCHS



Professional Tools

Just Provide  
Best Quality In The Class

Better thickness to  
provide more power, safety  
and more comfortable grip at work

Made from best Cr-V steel material  
with special hardened process  
for best durability



Meets or Exceeds  
ASME Standard

Lobed drive design  
reducing corner rounded of the fastener  
and provide longer life

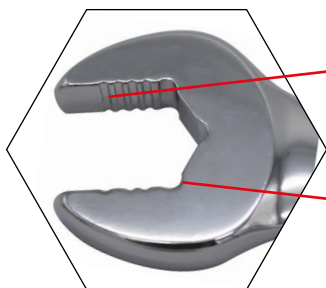

Non-Slip open-end design  
reduce slippery and more safety

Lobed open-end corner design  
provide more contact point  
and reducing fastener corner rounded

Hot forged body and thumbwheel  
Manufactured from high quality alloy steel

Ergonomic wide handle  
to provide more comfortable grip  
and reduce hand fatigue



Meets or Exceeds  
ASME Standard

Metric reading  
Measurements laser scale

**SAFETY NOTICE :**

DON'T STRIKE the Wrench.  
NEVER USE EXTENSIONS.  
DON'T USE OPEN END for TIGHTENING.  
ALWAYS USE RING END for TIGHTENING.  
DON'T USE ADJUSTABLE WRENCH for TIGHTENING or LOOSENING.  
ALWAYS PULL, NEVER PUSH the Wrench.  
NEVER SUBSTITUTE METRIC for INCHES or vice versa.  
NEVER USE a damage Wrench, Always replace a new Wrench.



WARNING ▲  
Always wear  
safety goggles

**COMBINATION WRENCH - HI-POWER SERIES**  
**METRIC SIZE 12 PT FULL POLISH FINISH**



Product Number	Opening Size (mm)	Weight (gr)	A Overall Length (mm)	B Width Open End (mm)	C Width Box End (mm)	D Thickness Open End (mm)	E Thickness Open End (mm)	F Width (mm)	G Thickness (mm)
*WM6P	6	21	124	14.7	10.0	3.8	5.6	6.2	2.6
*WM7P	7	21	129	15.7	11.2	4.1	5.8	6.2	2.6
*WM8P	8	28	136	17.9	12.4	4.2	6.4	7.4	2.9
*WM9P	9	43	149	20.2	14.4	5.1	7.4	8.9	3.5
*WM10P	10	54	161	22.6	16.6	5.4	7.6	9.6	3.9
*WM11P	11	58	168	23.9	16.7	5.4	8.0	10.2	3.9
*WM12P	12	71	174	25.9	18.6	5.8	8.4	11.0	4.4
*WM13P	13	79	180	26.2	19.4	5.8	8.4	11.4	4.5
*WM14P	14	104	193	30.2	21.9	6.6	8.8	12.6	4.8
*WM15P	15	124	200	32.1	22.4	7.4	9.0	13.2	5.1
*WM16P	16	135	207	33.4	23.8	7.4	10.2	13.8	5.3
*WM17P	17	169	228	36.6	26.1	7.9	10.9	15.0	5.7
*WM18P	18	207	239	38.5	27.1	8.8	11.3	15.6	5.9
*WM19P	19	230	250	40.1	28.2	9.0	11.7	16.2	6.3
*WM20P	20	-	260	41.9	29.6	9.1	12.3	16.8	6.5
*WM21P	21	280	271	42.9	31.7	9.3	12.5	17.4	6.7
*WM22P	22	340	295	45.2	32.1	9.7	13.3	18.6	7.1
*WM23P	23	340	295	45.2	32.1	9.7	13.3	18.6	7.1
*WM24P	24	410	317	51.4	34.0	10.0	14.0	19.8	7.4
**WM25S	25	485	339	51.4	36.0	10.9	14.7	20.9	8.3
**WM26S	26	485	339	51.4	36.0	10.9	14.7	20.9	8.3
**WM27S	27	640	360	57.9	40.4	11.5	15.4	22.8	8.9
**WM28S	28	740	394	57.9	41.8	12.3	16.3	23.4	9.1
**WM29S	29	740	394	57.9	41.8	12.3	16.3	23.4	9.1
**WM30S	30	740	394	57.9	41.8	12.3	16.3	23.4	9.1
**WM32S	32	880	427	65.4	45.0	13.3	17.8	25.9	9.5

\*\*Satin Finish  
\*Non-Slip Design & Full Polish Finish  
ASME B107-6

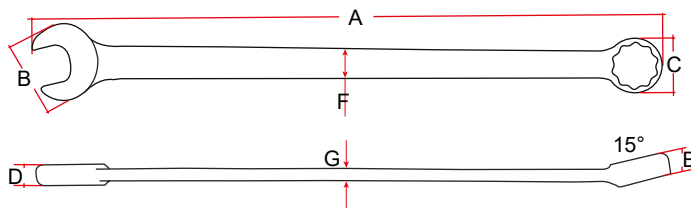

**COMBINATION WRENCH - HI-POWER SERIES  
INCH SIZE 12 PT FULL POLISH FINISH**

Product Number	Opening Size (inch)	Weight (gr)	A Overall Length (mm)	B Width Open End (mm)	C Width Box End (mm)	D Thickness Open End (mm)	E Thickness Open End (mm)	F Width (mm)	G Thickness (mm)
*WM08FP	1/4	21	124	14.7	10.0	3.8	5.6	6.2	2.6
*WM10FP	5/16	-	136	17.9	12.4	4.2	6.4	7.4	2.9
*WM12FP	3/8	27	149	20.2	14.4	5.1	7.4	8.9	3.5
*WM14FP	7/16	41	168	23.9	16.7	5.4	8.0	10.2	3.9
*WM16FP	1/2	57	180	26.2	19.4	5.8	8.4	11.4	4.5
*WM18FP	9/16	79	193	30.2	21.9	6.6	8.8	12.6	4.8
*WM20FP	5/8	101	207	33.4	23.8	7.4	10.2	13.8	5.3
*WM22FP	11/16	136	228	36.6	26.1	7.9	10.9	15.0	5.7
*WM24FP	3/4	166	250	40.1	28.2	9.0	11.7	16.2	6.3
*WM26FP	13/16	230	271	42.9	31.7	9.3	12.5	17.4	6.7
*WM28FP	7/8	-	295	45.2	32.1	9.7	13.3	18.6	7.1
*WM30FP	15/16	280	317	51.4	34.0	10.0	14.0	19.8	7.4
*WM32FP	1	340	339	51.4	36.0	10.9	14.7	20.9	8.3
**WM34FS	1-1/16		360	57.9	40.4	11.5	15.4	22.8	8.9
**WM36FS	1-1/8		394	57.9	41.8	12.3	16.3	23.4	9.1
**WM38FS	1-3/16		394	57.9	41.8	12.3	16.3	23.4	9.1
**WM40FS	1-1/4		427	65.4	45.0	13.3	17.8	25.9	9.5

\*\*Satin Finish

\*Non-Slip Design & Full Polish Finish

ASME B107-6

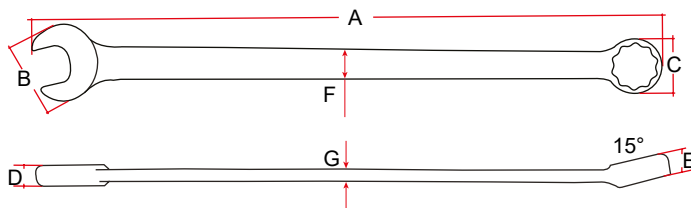

**ADJUSTABLE WRENCHS**

Product Number	A Length		B Opening Jaw	C Jaw Wide	D Handle Wide	Weight (lbs)
	inch	mm				
WA6	6	150	19	7.38	7.43	0.24
WA8	8	200	25	8.28	8.60	0.49
WA10	10	250	30	9.50	9.55	0.83
WA12	12	300	38	10.50	11.55	1.41

ASME B107.8

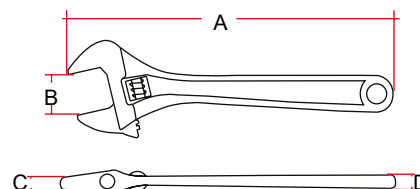



Push through design provide better safety socket locking and easier socket release

Made from best Cr-V steel material with special hardened processed provide more durability, safety and comfortable at work



72 Teeth Gears provide more durability

Meets or Exceeds ASME Standard

Ergonomic design handle provide more comfortable grip and reduce fatigue

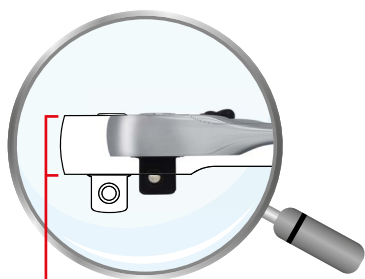

Thin profile and smaller ratchet head provide better access for tight area



Cr-Mo steel material with heat treated provide more durability

72 Teeth smooth gears can be operated on tight space area

Thin wall design provide better access

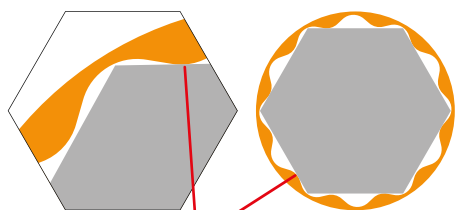

Lobed drive design reducing corner rounded of the fastener and provide longer life



Made from best Cr-V composition steel material with special hardened processed for best durability

Cold-forged processing provide more precision size

Bigger font size for easier size identification

Meets or Exceeds ASME Standard

**SAFETY NOTICE :**

DON'T STRIKE the socket.  
ALWAYS PULL, NEVER PUSH the RATCHET.  
NEVER SUBSTITUTE MATRIC for INCHES or vice versa  
NEVER USE a DAMAGE SOCKET, Always replace a new socket.  
DON'T USE HAND SOCKET for POWER or IMPACT application.



**WARNING ▲**  
Always wear safety goggles

**SOCKET 1/4" Dr - HI-POWER SERIES  
STANDARD LENGTH 6PT METRIC**

Product Number	Opening Size (mm)	Weight (gr)	A Drive End (mm)	B Wrench End (mm)	C Overall Length (mm)
S1405P	5	40	11.76	8.03	24.84
S1483P	5.5	45	11.79	8.47	24.72
S1406P	6	50	11.69	9.30	24.68
S1407P	7	50	11.79	10.72	24.83
S1408P	8	50	11.86	11.73	24.76
S1409P	9	50	12.88	12.80	24.68
S1410P	10	50	14.23	14.37	24.87
S1411P	11	50	15.87	15.90	24.81
S1412P	12	50	16.86	16.73	24.66
S1413P	13	60	17.91	17.72	24.71
S1414P	14	80	19.47	19.46	24.84

ASME B107.110

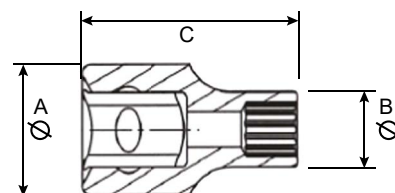
**SOCKET 1/4" Dr - HI-POWER SERIES  
STANDARD LENGTH 6PT INCH**

Product Number	Opening Size (inch)	Weight (gr)	A Drive End (mm)	B Wrench End (mm)	C Overall Length (mm)
S1406FP	3/16"	45	11.91	7.54	24.94
S1407FP	7/32"	45	11.84	8.72	24.78
S1408FP	1/4"	50	11.66	8.80	24.63
S1409FP	9/32"	50	11.76	10.74	24.50
S1410FP	5/16"	50	11.84	11.97	24.93
S1411FP	11/32"	70	12.86	12.78	24.79
S1412FP	3/8"	65	14.15	14.47	24.69
S1414FP	7/16"	75	15.91	15.73	24.83
S1416FP	1/2"	90	17.41	17.39	24.70

ASME B107.110

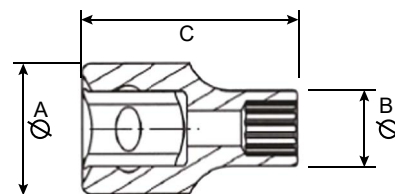

### RATCHET 1/4" DRIVE REVERSIBLE



Product Number	Size (inch)	Weight (gr)	D1 Head Width (mm)	D2 Head Depth (mm)	L Overall Length (mm)
SAR14	1/4"	410	30	9.5	138

ASME B107.110

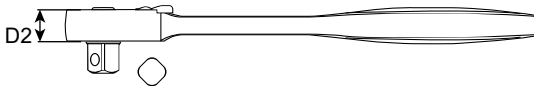
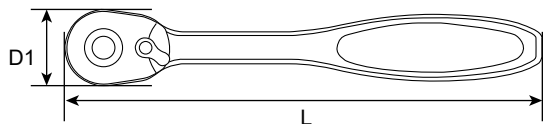

### 1/4" Dr, FLEX HANDLE

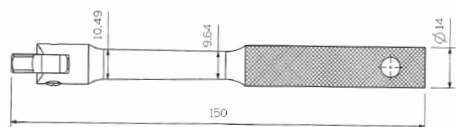

Product Number	Size (inch)	Weight (gr)	D Drive End (mm)	L Overall Length (mm)
SAHH14P	6"	410	14.09	149.98

ASME B107.110



### 1/4" Dr, EXTENSIONS

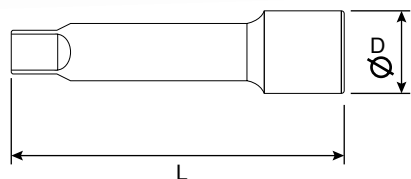

Product Number	Size (inch)	Weight (gr)	D Drive End (mm)	L Overall Length (mm)
SAE142P	2"	410	11.94	50.10
SAE146P	6"	410	12.05	149.98

ASME B107.110

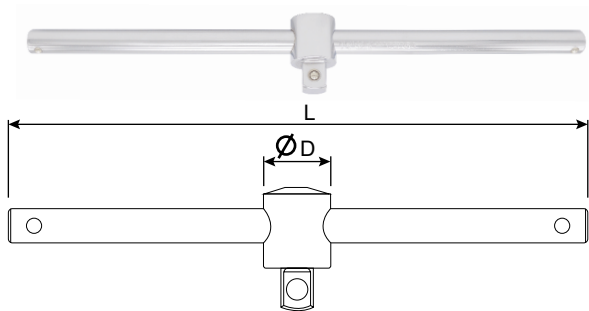

### 1/4" Dr, SLIDING T HANDLE

Product Number	Size (inch)	Weight (gr)	D Drive End (mm)	L Overall Length (mm)
SATH14P	4-1/2"	410	14.02	114.84

ASME B107.110

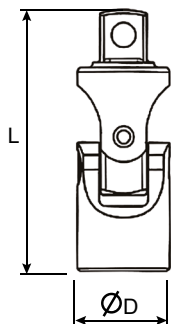

### 1/4" Dr, UNIVERSAL JOINT

Product Number	Weight (gr)	D Drive End (mm)	L Overall Length (mm)
SAUJ14P	410	13.91	38.12

ASME B107.110

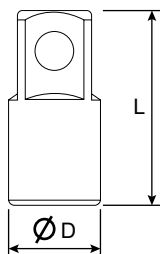

### 1/4" Dr, ADAPTER

Product Number	Size (inch)	Weight (gr)	D Drive End (mm)	L Overall Length (mm)
SAA1438P	F1/4 x M3/8	410	11.97	25.12

ASME B107.110

**SOCKET 3/8" Dr - HI-POWER SERIES  
STANDARD LENGTH 12PT METRIC**

Product Number	Opening Size (mm)	Weight (gr)	A Drive End (mm)	B Wrench End (mm)	C Overall Length (mm)
S3806P	6	40	16.84	9.84	29.96
S3807P	7	45	16.87	10.60	29.92
S3808P	8	50	16.92	11.99	30.05
S3809P	9	50	16.80	13.27	30.03
S3810P	10	50	16.82	14.45	29.98
S3811P	11	50	16.93	15.60	30.02
S3812P	12	50	16.91	16.94	30.01
S3813P	13	50	17.71	17.73	30.04
S3814P	14	50	19.80	19.66	30.09
S3815P	15	60	20.91	21.06	29.94
S3816P	16	80	21.70	21.70	29.92
S3817P	17	50	23.52	23.62	30.10
S3818P	18	50	24.45	24.38	30.07
S3819P	19	50	25.55	25.53	30.08
S3820P	20	50	27.27	27.18	29.97
S3821P	21	50	27.90	27.86	30.02
S3822P	22	50	29.73	29.58	30.10
S3823P	23	60	31.08	31.04	30.09

ASME B107.110

**SOCKET 3/8" Dr - HI-POWER SERIES  
STANDARD LENGTH 12PT INCH**

Product Number	Opening Size (inch)	Weight (gr)	A Drive End (mm)	B Wrench End (mm)	C Overall Length (mm)
S3808FP	1/4"	45	16.78	9.84	29.84
S3810FP	5/16"	45	16.80	11.52	30.02
S3812FP	3/8"	50	16.93	14.15	30.04
S3814FP	7/16"	50	16.78	16.79	29.98
S3816FP	1/2"	50	17.81	17.79	29.98
S3818FP	9/16"	70	19.73	19.73	30.01
S3820FP	5/8"	65	21.88	21.81	30.03
S3822FP	11/16"	75	23.85	23.91	30.04
S3824FP	3/4"	90	25.41	25.48	29.97
S3826FP	13/16"	70	27.91	28.02	30.02
S3828FP	7/8"	65	29.96	29.87	30.04
S3830FP	15/16"	75	32.05	31.88	30.02
S3832FP	1"	90	34.02	33.85	29.81

ASME B107.110

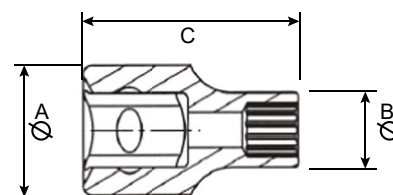
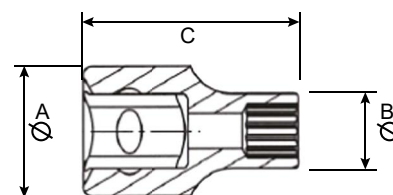

### RATCHET 3/8" DRIVE REVERSIBLE



Product Number	Size (inch)	Weight (gr)	D1 Head Width (mm)	D2 Head Depth (mm)	L Overall Length (mm)
SAR38	3/8"	410	30.5	12.5	192

ASME B107.110

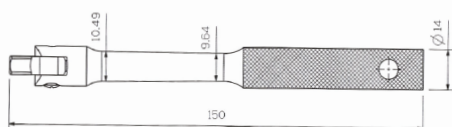
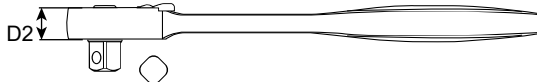
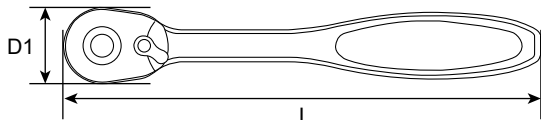

### 3/8" Dr, FLEX HANDLE

Product Number	Size (inch)	Weight (gr)	D Drive End (mm)	L Overall Length (mm)
SAHH38P	8"	410	15.90	200.03

ASME B107.110

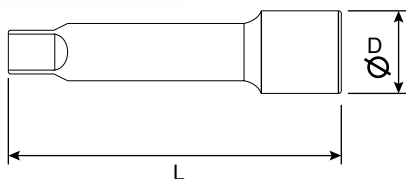

### 3/8" Dr, EXTENSIONS

Product Number	Size (inch)	Weight (gr)	D Drive End (mm)	L Overall Length (mm)
SAE383P	3"	410	18.03	74.94
SAE386P	6"	410	18.05	149.90
SAE388P	8"	410	18.73	199.90

ASME B107.110

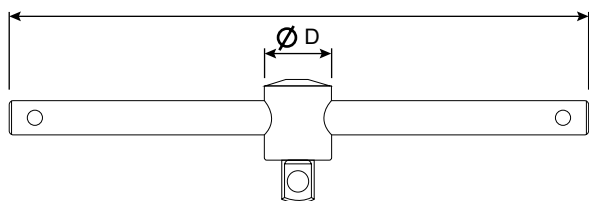

### 3/8" Dr, SLIDING T HANDLE

Product Number	Size (inch)	Weight (gr)	D Drive End (mm)	L Overall Length (mm)
SATH38P	6-1/2"	410	20.03	14.90

ASME B107.110

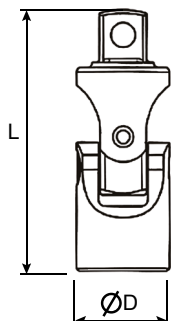

### 3/8" Dr, UNIVERSAL JOINT

Product Number	Weight (gr)	D Drive End (mm)	L Overall Length (mm)
SAUJ38P	410	18.90	57.03

ASME B107.110

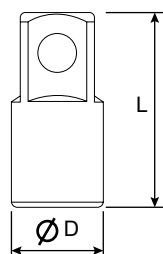

### 3/8" Dr, ADAPTERS

Product Number	Size (inch)	Weight (gr)	D Drive End (mm)	L Overall Length (mm)
SAA3814P	F3/8 x M1/4	410	16.96	27.03
SAA3812P	F3/8 x M1/2	410	17.93	36.08

ASME B107.110

**SOCKET 1/2" Dr - HI-POWER SERIES  
STANDARD LENGTH 12PT METRIC**

Product Number	Opening Size (mm)	Weight (gr)	A Drive End (mm)	B Wrench End (mm)	C Overall Length (mm)
S1208P	8	40	21.88	13.14	37.92
S1209P	9	45	21.91	14.28	37.92
S1210P	10	50	21.96	15.35	37.94
S1211P	11	50	21.94	16.42	38.05
S1212P	12	50	22.08	17.84	38.05
S1213P	13	50	22.05	18.95	37.96
S1214P	14	50	22.05	21.49	37.96
S1215P	15	50	22.05	23.10	37.90
S1216P	16	50	22.09	23.92	38.03
S1217P	17	60	22.60	20.39	38.06
S1218P	18	80	23.92	25.03	38.01
S1219P	19	80	24.46	25.52	37.92
S1220P	20	90	26.09	27.93	38.02
S1221P	21	90	26.91	28.88	38.04
S1222P	22	100	28.09	29.90	40.04
S1223P	23	120	28.98	30.87	40.04
S1224P	24	120	30.03	32.71	40.10
S1225P	25	140	30.90	33.10	41.92
S1226P	26	160	31.92	35.02	42.10
S1227P	27	170	33.05	35.83	45.07
S1228P	28	200	33.05	37.63	45.08
S1229P	29	190	34.07	38.98	44.97
S1230P	30	220	33.95	39.86	45.02
S1232P	32	250	35.90	42.07	44.96

ASME B107.110

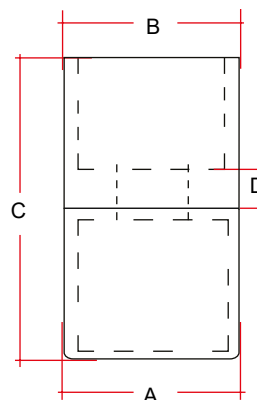

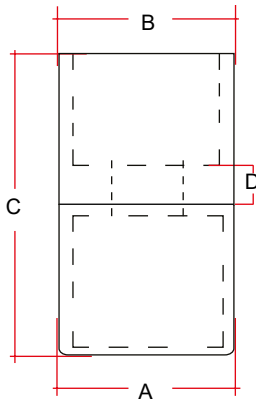
**SOCKET 1/2" Dr - HI-POWER SERIES  
STANDARD LENGTH 12PT INCH**

Product Number	Opening Size (inch)	Weight (gr)	A Drive End (mm)	B Wrench End (mm)	C Overall Length (mm)
S1212FP	3/8"	40	14.60	22.20	38.00
S1214FP	7/16"	45	18.00	22.20	38.00
S1216FP	1/2"	50	19.00	22.20	38.00
S1218FP	9/16"	50	20.60	22.20	38.00
S1220FP	5/8"	50	22.20	22.20	38.00
S1221FP	21/32"	50	22.80	22.80	38.00
S1222FP	11/16"	50	23.95	23.95	38.00
S1224FP	3/4"	50	26.50	24.50	38.00
S1226FP	13/16"	50	28.70	27.00	38.00
S1228FP	7/8"	60	29.85	28.00	40.00
S1230FP	15/16"	80	32.80	30.00	40.00
S1232FP	1"	80	33.85	32.00	42.00
S1234FP	1-1/16"	90	35.85	33.00	45.00
S1236FP	1-1/8"	90	39.00	34.00	45.00
S1238FP	1-3/16"	100	39.85	34.00	45.00
S1240FP	1-1/4"	120	42.00	36.00	45.00

ASME B107.110

### RATCHET 1/2" DRIVE REVERSIBLE

Product Number	Overall Length		Diameter Head		C Depth Head		D Width	E Depth	Number of Teeth	Weight (gr)
	inch	mm	inch	mm	inch	mm				
SAR12G	10	250	1.5	38	0.8	20.3	0.88	0.3	72	580

ASME B107.10



### RATCHET 1/2" DRIVE REVERSIBLE

Product Number	Size (inch)	Weight (gr)	D1 Head Width (mm)	D2 Head Depth (mm)	L Overall Length (mm)
SAR12	1/2"	410	38.5	16.7	260

ASME B107.110

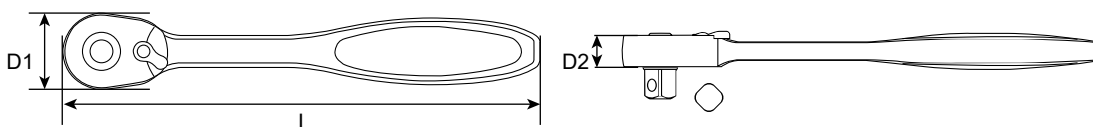

### 1/2" Dr, HINGE HANDLE

Product Number	Overall Length (inch)	Weight (gr)
SAHH12	15	700

ASME B107.10



### 1/2" Dr, FLEX HANDLE

Product Number	Size (inch)	Weight (gr)	D Drive End (mm)	L Overall Length (mm)
SAHH12P	12"	410	17.01	299.96

ASME B107.110

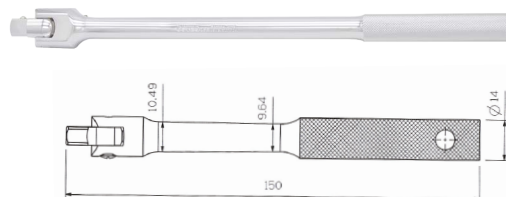

### 1/2" Dr, EXTENSIONS

Product Number	Overall Length (inch)	Weight (gr)
SAE122	2	100
SAE123	3	140
SAE125	5	220
SAE1210	10	430

ASME B107.10



### 1/2" Dr, EXTENSIONS

Product Number	Size (inch)	Weight (gr)	D Drive End (mm)	L Overall Length (mm)
SAE122P	2"	100	23.97	50.12
SAE123P	3"	140	24.06	74.98
SAE1210P	10"	230	23.97	249.97

ASME B107.110

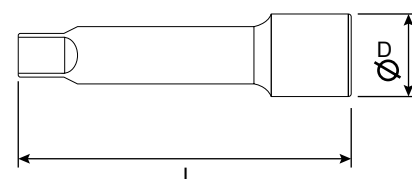



**1/2" Dr, SPEED HANDLE**

Product Number	Overall Length (inch)	Weight (gr)
SASH12	18"	700

ASME B107.10



**1/2" Dr, SPEED HANDLE**

Product Number	Overall Length (inch)	Weight (gr)	D Drive End (mm)	L Overall Length (mm)
SASH12P	16"	700	12.80	409.98

ASME B107.110



**1/2" Dr, SLIDING T HANDLE**

Product Number	Overall Length (inch)	Weight (gr)
SASH12	18"	700

ASME B107.10



**1/2" Dr, SLIDING T HANDLE**

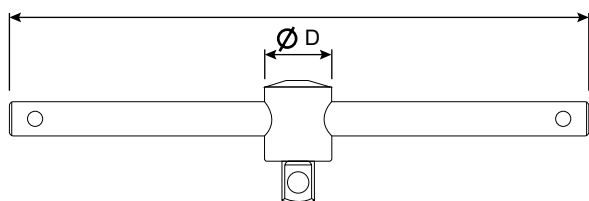

Product Number	Overall Length (inch)	Weight (gr)	D Drive End (mm)	L Overall Length (mm)
SATH12P	12"	410	24.90	299.97

ASME B107.110



**1/2" Dr, UNIVERSAL JOINT**

Product Number	Weight (gr)
SAUJ12	700

ASME B107.10

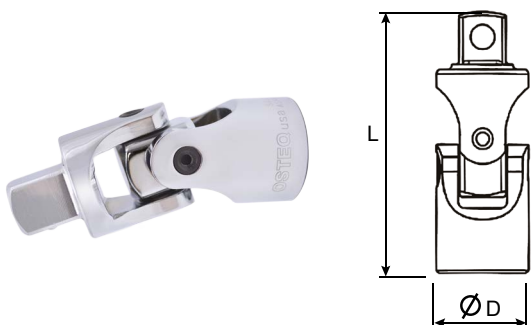

**1/2" Dr, UNIVERSAL JOINT**

Product Number	Weight (gr)	D Drive End (mm)	L Overall Length (mm)
SAUJ12P	160	25.04	73.01

ASME B107.110

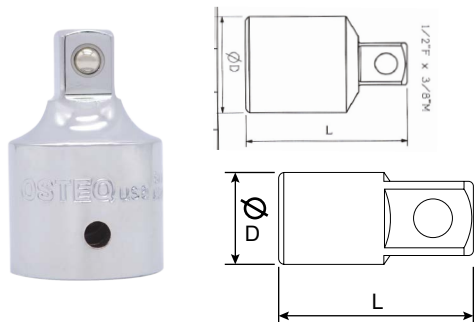

**1/2" ADAPTORS**

Product Number	Overall Length (inch)	Weight (gr)	D Drive End (mm)	L Overall Length (mm)
SAA1238P	F 1/2 x M3/8	-	21.97	35.09
SAA1234P	F 1/2 x M3/4	-	26.06	45.02

ASME B107.110

**SOCKET 3/4" Dr - HI-POWER SERIES  
STANDARD LENGTH 12PT METRIC**

Product Number	Opening Size (mm)	Weight (gr)	L (mm)	D1 (mm)	D2 (mm)	L1 (mm)	L2 (mm)	D3 (mm)
S3417	17	-	49.5	28	36	16	24	17.2
S3419	19	45	49.5	30	36	16	24	17.2
S3421	21	50	49.5	32	36	16	24	17.2
S3422	22	50	49.5	33	36	16	24	17.2
S3423	23	50	49.5	34	36	16	24	17.2
S3424	24	50	49.5	35	36	16	24	17.2
S3425	25	50	50	36	36	16	24	-
S3426	26	50	50	37	36	16	24	-
S3427	27	50	52	38	36	16	24	-
S3428	28	60	52	39	36	21	24	-
S3429	29	80	52	40	38	21	24	-
S3430	30	80	54	42	38	22	24	-
S3432	32	90	56	44	38	24.6	24	-
S3433	33	90	56	46	38	24.6	24	-
S3434	34	100	58	46	38	25.6	24	-
S3435	35	120	58	48	42	25.6	24	-
S3436	36	120	58	50	42	25.6	24	-
S3438	38	140	60	52	45	29	24	-
S3440	40	160	64	56	45	30	24	-
S3441	41	170	64	56	45	31	24	-
S3442	42	200	64	56	45	31	24	-
S3446	46	190	68	62	48	33	24	-
S3448	48	220	70	65	48	37.8	24	-
S3450	50	250	72	68	48	37.8	24	-

ASME B107.110

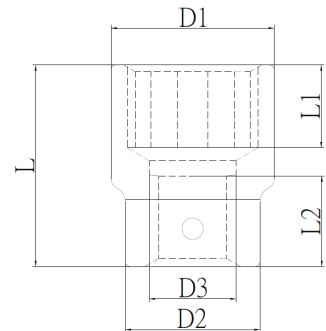

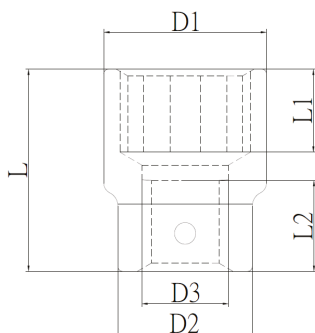
**SOCKET 3/4" Dr - HI-POWER SERIES  
STANDARD LENGTH 12PT INCH**

Product Number	Opening Size (inch)	Weight (gr)	L (mm)	D1 (mm)	D2 (mm)	L1 (mm)	L2 (mm)	D3 (mm)
S3424F	3/4"	-	49.28	29.97	35.81	16.00	23.88	17.02
S3426F	13/16"	45	49.28	31.75	35.81	16.00	23.88	17.02
S3428F	7/8"	50	49.28	32.77	35.81	16.00	23.88	17.02
S3430F	15/16"	50	49.28	34.8	35.81	16.00	23.88	17.02
S3432F	1"	50	49.78	36.83	35.81	16.00	23.88	17.02
S3434F	1-1/16"	70	51.82	37.85	35.81	16.00	23.88	17.02
S3436F	1-1/8"	65	51.82	39.88	37.85	20.83	23.88	-
S3438F	1-3/16"	75	53.85	41.91	37.85	21.84	23.88	-
S3440F	1-1/4"	90	55.88	43.94	37.85	24.38	23.88	-
S3442F	1-5/16"	110	55.88	45.72	37.85	24.38	23.88	-
S3444F	1-3/8"	130	57.66	47.75	41.91	25.40	23.88	-
S3446F	1-7/16"	160	57.66	49.78	41.91	25.40	23.88	-
S3448F	1-1/2"	170	59.69	51.82	44.70	28.96	23.88	-
S3450F	1-9/16"	200	61.72	54.86	44.70	29.97	23.88	-
S3452F	1-5/8"	240	63.75	55.88	44.70	30.99	23.88	-
S3454F	1-11/16"	260	64.77	57.66	44.70	32.26	23.88	-
S3456F	1-3/4"	170	65.79	59.69	47.75	32.26	23.88	-
S3458F	1-13/16"	200	67.82	61.72	47.75	32.77	23.88	-
S3460F	1-7/8"	240	69.85	63.75	47.75	34.29	23.88	-
S3464F	2"	260	71.63	67.82	47.75	37.59	23.88	-

ASME B107.110

**RATCHET 3/4" DRIVE REVERSIBLE**

Product Number	Size (inch)	Weight (gr)	D1 Head Width (mm)	D2 Head Depth (mm)	L Overall Length (mm)
SAR34	3/4"	410	63.78	24.92	520

ASME B107.110

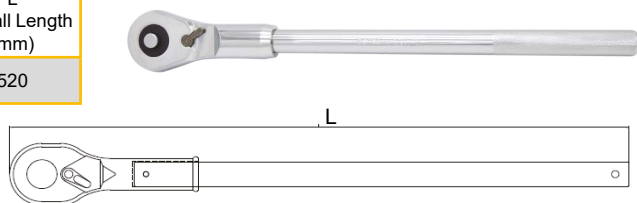

**3/4" Dr, HINGE HANDLE**

Product Number	L Overall Length		Weight (gr)	D1 (mm)
	(mm)	(inch)		
SAHH34	475	19"	-	19.2

ASME B107.110

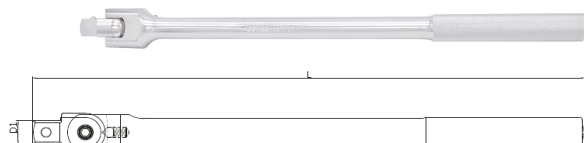

**3/4" Dr, EXTENSIONS**

Product Number	L Overall Length		Weight (gr)	D1 (mm)	D2 (mm)
	(mm)	(inch)			
SAE344	100	4"	-	36	19.2
SAE346	150	6"	-	36	19.2
SAE348	200	8"	-	36	19.2

ASME B107.110

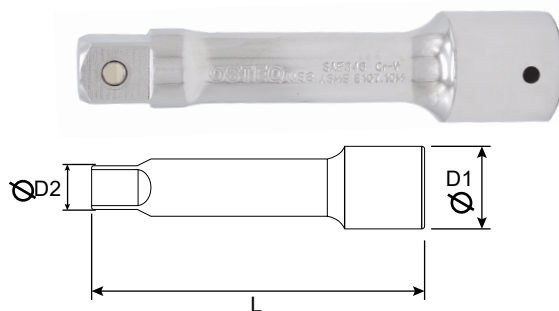

**3/4" Dr, UNIVERSAL JOINT**

Product Number	Weight (gr)	L Overall Length		D1 (mm)	D2 (mm)
		(mm)	(inch)		
SAUJ34	-	109	4-5/16"	19.2	39.8

ASME B107.110

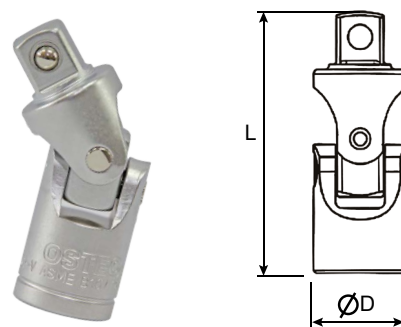

**3/4" ADAPTOR**

Product Number	Opening Size (inch)	L Overall Length		D1 (mm)	D2 (mm)
		(mm)	(inch)		
SAA3412	F3/4" x M1/2"	55	2-1/8"	12.6	36

ASME B107.110

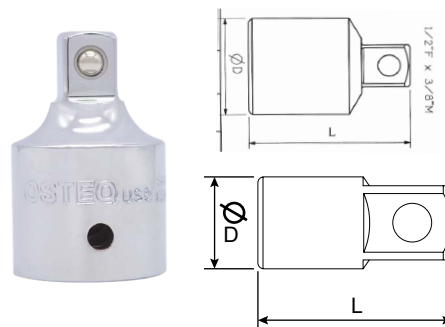

USA

SCREWDRIVERS



Professional Tools

Just Provide Best Quality In The Class

Meets or Exceeds ASME Standard

Handle manufactured by PP & TPR provide more comfort grip and impact resistance

 Magnetic Tip

Manufactured from best Cr-V steel with special heated treatment for better durability

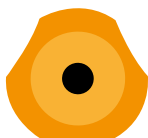

Tri-point ergonomic handle design provide maximum turning power, more comfort and more safety

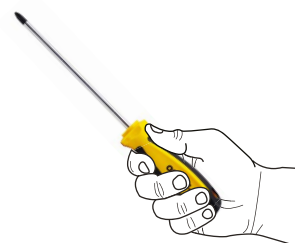

Manufactured from best Cr-V steel with special heated treatment for better durability

Handle manufactured by PP & TPR provide more comfort grip, reduce slipping and impact resistance

 Magnetic Tip



AC 1000V  
IEC 60900

Heat pressure test up to 70°C  
Cold Impact test -10°C to -25°C  
Safety working guarantee up to 1000 V

100% piece-by-piece under water insulation resistance test, up to 10.000 V



WARNING ▲  
Always wear safety goggles

**SAFETY NOTICE :**

DON'T USE SCREWDRIVER as PRY BARS, PUNCHING OR CHISELLING.  
NEVER USE a CHIPPED or ROUNDED tips, Always REPLACE a NEW SCREWDRIVER.  
ALWAYS be MATCHED the SCREWDRIVER TIP size TO the SLOT of SCREW SIZE.



**SCREWDRIVER PHILLIPS TIP**

Product Number	A1 Tip Size	A2 Tip Width (mm)	B Blade Length (mm)	C Blade Dia. (mm)	D Handle Length (mm)	E Handle Size Dia. (mm)	F Overall Length (mm)	Weight
*DP2x38A	#2	6.5	38	6.0	63	34.5	101	42
DP0x75A	#0	3.0	75	3.0	86.5	28	161.5	37
DP1x75A	#1	5.5	75	5.0	101	33	176	59
DP1x100A	#1	5.5	100	5.0	101	33	201	63
DP2x100A	#2	6.5	100	6.0	111	36	211	85
DP2x150A	#2	6.5	150	6.0	111	36	261	99
DP3x150A	#3	8.0	150	8.0	120	39	270	144
DP3x200A	#3	8.0	200	8.0	120	39	320	165

\*Stubby  
ASME B107.600

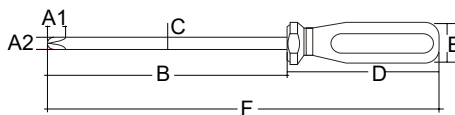

**SCREWDRIVER SLOTTED TIP**

Product Number	A1 Tip Thickness (mm)	A2 Tip Width (mm)	B Blade Length (mm)	C Blade Dia. (mm)	D Handle Length (mm)	E Handle Size Dia. (mm)	F Overall Length (mm)	Weight
*DS6x38A	1.2	6.5	38	6.0	63	34.5	101	42
DS3x75A	0.5	3.0	75	3.0	86.5	28	161.5	37
DS5x75A	1.0	5.5	75	5.0	101	33	176	59
DS5x100A	1.0	5.5	100	5.0	101	33	201	63
DS6x100A	1.2	6.5	100	6.0	111	36	211	85
DS6x150A	1.2	6.5	150	6.0	111	36	261	99
DS8x150A	1.6	8.0	150	8.0	120	39	270	144
DS8x200A	1.6	8.0	200	8.0	120	39	320	165

\*Stubby  
ASME B107.600

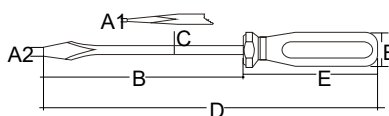



### SCREWDRIVER SLOTTED TIP - INSULATED

Product Number	A1 Tip Thickness (mm)	A2 Tip Width (mm)	B Blade Length (mm)	C Blade Dia. (mm)	D Handle Length (mm)	E Handle Size Dia. (mm)	F Overall Length (mm)	Weight
D540A6	0.5	3.0	100	3.0	88	27	188	51
D540A4	0.8	4.0	100	4.0	88	27	188	56
D540A3	1.0	5.5	125	5.5	100	31	225	75
D540A2	1.2	6.5	150	6.5	110	34	260	83

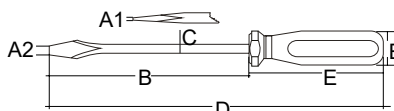

AC 1000V  
IEC 60900



### SCREWDRIVER PHILLIPS TIP - INSULATED

Product Number	A Tip Size	B Blade Length (mm)	C Blade Dia. (mm)	D Handle Length (mm)	E Handle Size Dia. (mm)	F Overall Length (mm)	Weight
D540B4	PH0	60	3.0	88	27	148	49
D540B3	PH1	80	5.0	100	31	180	60
D540B2	PH2	100	6.0	110	34	210	72
D540B1	PH3	150	8.0	120	38	270	85

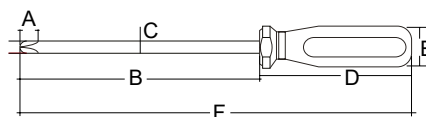

AC 1000V  
IEC 60900

USA



Professional Tools

Just Provide  
Best Quality In The Class



**LINESMAN PLIERS Smooth Design**

Product Number	A Overall Length (inch)	B Jaw Length (inch)	C Jaw Width (inch)	D Jaw Thickness (inch)	Weight (gr)
PLP07DB	7.2	1.51	1.06	0.41	300
PLP08DB	8	1.63	1.16	0.45	350

DIN 5244



**DIAGONAL CUTTING PLIERS Smooth Design**

Product Number	A Overall Length (inch)	B Jaw Length (inch)	C Jaw Width (inch)	D Jaw Thickness (inch)	Weight (gr)
PDC06DB	6.2	0.82	0.85	0.40	240
PDC07DB	7.2	1.00	0.95	0.44	275

DIN 5238



**LOCKING PLIERS CURVE JAW with Wire Cutter**

Product Number	A Overall Length		B Jaw Length		C Jaw Width	D Jaw Thickness	Weight (gr)
	inch	mm	inch	mm	mm	inch	
P0600010	10	250	1.6	41	5	0.45	550

ASME B107.24

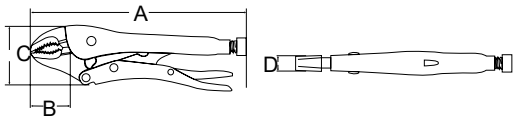

## GROOVE JOINT PLIERS

Product Number	A Overall Length (inch)	B Jaw Length (inch)	C Jaw Width (inch)	D Jaw Thickness (inch)	Weight (gr)
PGJ10A	10	1.90	2.06	0.44	450

ASME B107.23

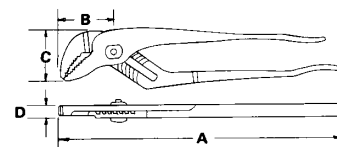

## SLIP JOINT PLIERS

Product Number	A Overall Length (inch)	B Jaw Length (inch)	C Jaw Width (inch)	D Jaw Thickness (inch)	Weight (gr)
PSJ08A	8.6	1.89	1.30	0.34	290

ASME B107.13

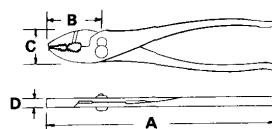

## DIAGONAL CUTTING PLIERS

Product Number	A Overall Length (inch)	B Jaw Length (inch)	C Jaw Width (inch)	D Jaw Thickness (inch)	Weight (gr)
PDC06A	6.5	0.74	0.78	0.37	190
PDC75A	7.5	1	0.87	0.38	250

ASME B107.11

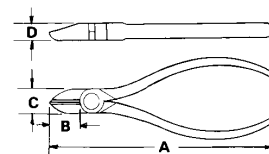

## LINESMAN PLIERS

Product Number	A Overall Length (inch)	B Jaw Length (inch)	C Jaw Width (inch)	D Jaw Thickness (inch)	Weight (gr)
PLP07A	7.2	1.28	0.95	0.5	320
PLP08A	8.2	1.50	1.03	0.5	380

ASME B107.20

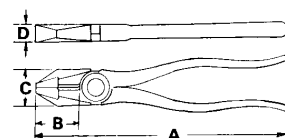

## LONG NOSE PLIERS W/ WIRE CUTTER

Product Number	A Overall Length (inch)	B Jaw Length (inch)	C Jaw Width (inch)	D Jaw Thickness (inch)	Weight (gr)
PLN06A	6.5	1.98	0.72	0.37	160
PLN08A	8	2.41	0.86	0.41	260

ASME B107.13

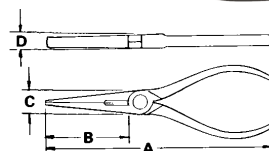



Manufactured from  
forged high alloy steel, tempered & annealed  
to avoid any distortion, fractures.



Meets or Exceeds ASME B107.400M Standard

Polish Finish Head

**BALL PEIN HAMMER HICKORY HANDLE**

Product Number	Weight		A (mm)	B (mm)	C Length (inch)	Weight (gr)
	Qz	Lbs				
HBP08H	8	0.5	25.60	82.34	11.41	340
HBP12H	12	0.75	28.27	91.69	12.60	480
HBP16H	16	1.0	30.26	103.70	13.77	620
HBP24H	24	1.5	37.31	117.46	14.17	910
HBP32H	32	2.0	40.43	129.10	15.35	1200

ASME B107.400

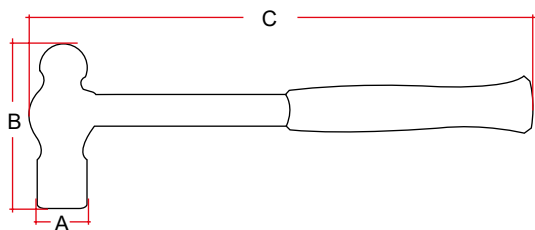

**WARNING ▲**  
Always wear  
safety goggles

**SAFETY NOTICE :**

Don't use extension on the handle.  
Never regrind, weld or reheat-treat a hammer.  
Never strike with the side or cheek of the hammer.  
Avoid glancing blows to minimize chipping of the hammer.  
Always select 3/8 larger surface hammer than struck surface.  
Never use striking or struck tool with loose or damaged handle.  
Discard any hammer show of dents, cracks, chips, mushrooming or excessive wear.

Manufactured from forged high alloy steel, tempered & annealed to avoid any distortion, fractures.

Fiberglass handle with PP & TPR material on the grip provide lower vibration

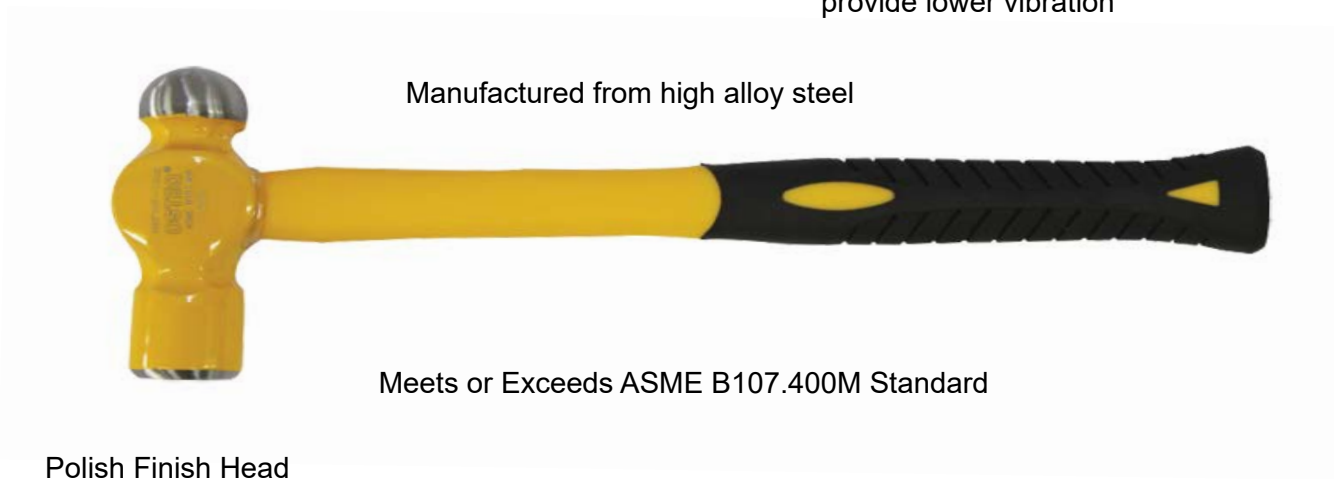

Manufactured from high alloy steel

Meets or Exceeds ASME B107.400M Standard

Polish Finish Head

**BALL PEIN HAMMER FIBERGLASS HANDLE**

Product Number	Weight		A (mm)	B (mm)	C Length (inch)	Weight (gr)
	Qz	Lbs				
HBP08F	8	0.5	24.76	82.42	11.41	360
HBP12F	12	0.75	28.08	92.34	12.60	520
HBP16F	16	1.0	29.14	103.72	13.77	630
HBP24F	24	1.5	37.41	117.80	14.17	940
HBP32F	32	2.0	40.37	129.29	15.35	1200

ASME B107.400

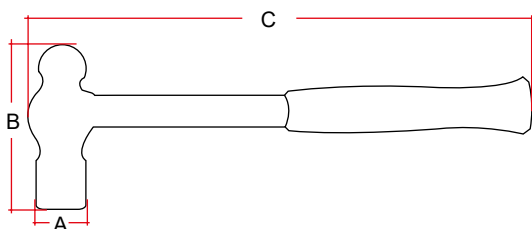

**SAFETY NOTICE :**  
 Don't use extension on the handle.  
 Never regrind, weld or reheat-treat a hammer.  
 Never strike with the side or cheek of the hammer.  
 Avoid glancing blows to minimize chipping of the hammer.  
 Always select 3/8 larger surface hammer than struck surface.  
 Never use striking or struck tool with loose or damaged handle.  
 Discard any hammer show of dents, cracks, chips, mushrooming or excessive wear.





Fiberglass handle  
with PP & TPR material on the grip  
provide lower vibration



Meets or Exceeds ASME B107.53M-2004 Standard

Polish Finish Head

**BALL PEIN HAMMER, BRASS, FIBERGLASS HANDLE**

Product Number	Weight		C Length (inch)	Weight (gr)
	Qz	Lbs		
TB07A-0120-U012	12	3/4	9.06	230
TB07A-0120-U016	16	1	13.39	340
TB07A-0120-U024	24	1-1/2	17.72	450
TB07A-0120-U032	32	2	26.77	680

ASME B.107.53M-2004



**WARNING ▲**  
Always wear safety goggles

**SAFETY NOTICE :**

Don't use extension on the handle.  
Never regrind, weld or reheat-treat a hammer.  
Never strike with the side or cheek of the hammer.  
Avoid glancing blows to minimize chipping of the hammer.  
Always select 3/8 larger surface hammer than struck surface.  
Never use striking or struck tool with loose or damaged handle.  
Discard any hammer show of dents, cracks, chips, mushrooming or excessive wear.



Fiberglass handle  
with PP & TPR material on the grip  
provide lower vibration



Meets or Exceeds ASME B107.54M-2001 Standard

Polish Finish Head

**SLEDGE HAMMER, BRASS, FIBERGLASS HANDLE**

Product Number	Weight		C Length (inch)	Weight (gr)
	Qz	Lbs		
TB07A-0220-U001	450	1	11.81	450
TB07A-0220-U002	910	2	13.78	910
TB07A-0220-U003	1400	3	15.75	1400
TB07A-0220-U004	1800	4	15.75	1800
TB07A-0220-U005	2250	5	15.75	2250
TB07A-0220-U006	2700	6	27.56	2700
TB07A-0220-U008	3600	8	27.56	3600
TB07A-0220-U010	4500	10	35.43	4500
TB07A-0220-U012	5400	12	35.43	5400
TB07A-0220-U014	6400	14	35.43	6400
TB07A-0220-U016	7200	16	35.43	7200
TB07A-0220-U020	9000	20	35.43	9000

ASME B.107.54-2001

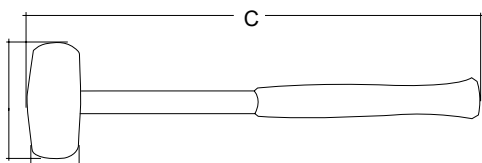

**WARNING** ▲  
Always wear safety goggles

**SAFETY NOTICE :**

Don't use extension on the handle.  
Never regrind, weld or reheat-treat a hammer.  
Never strike with the side or cheek of the hammer.  
Avoid glancing blows to minimize chipping of the hammer.  
Always select 3/8 larger surface hammer than struck surface.  
Never use striking or struck tool with loose or damaged handle.  
Discard any hammer show of dents, cracks, chips, mushrooming or excessive wear.

Heavy duty application

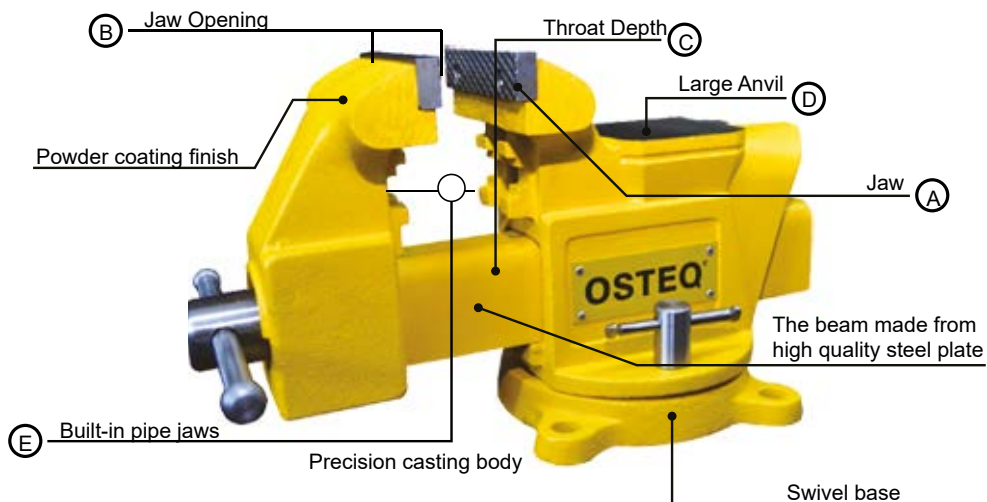

Meets or Exceeds  
ASME A48CL30 Standard

**HEAVY DUTY AMERICAN BENCH VISE with PIPE JAWS**

Product Number	Size	A Jaw	B Jaw Opening	C Throat Depth	D Large Anvil	E Pipe JawsΦ	Swivel°	Nett Weight (gr)
HCBV04	4"	100	125	88	72 x 70	12 - 64	120	13000
HCBV06	6"	150	175	107	90 x 100	12 - 74	120	27000
HCBV08	8"	200	200	115	95 x 100	17 - 88	360	29500

ASME A48CL30



WARNING ▲  
Always wear  
safety goggles

Standard duty application

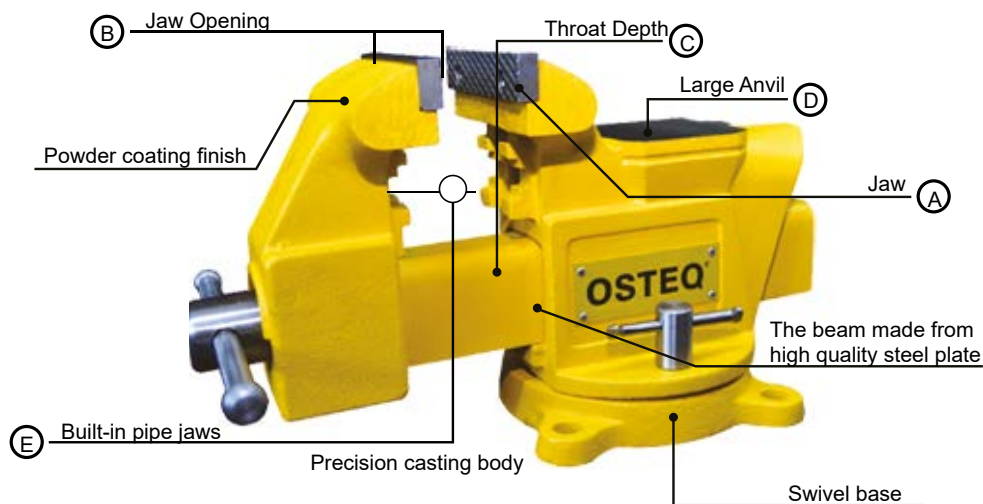

Meets or Exceeds  
ASME A48CL30 Standard

**AMERICAN BENCH VISE with PIPE JAWS**

Product Number	Size	A Jaw	B Jaw Opening	C Throat Depth	D Large Anvil	E Pipe JawsΦ	Swivel°	Nett Weight (gr)
HCBV05S	5"	125	102	88	72 x 70	9 - 64	120	11.500

ASME A48CL30



WARNING ▲  
Always wear  
safety goggles

USA



Professional Tools

HEAVY DUTY  
GREASE GUN  
400 CC

Just Provide  
Best Quality In The Class



### HEAVY DUTY GREASE GUN 400cc Max Pressure 12.000PSI

Product Number	Dimension		Weight / gr	
	Wide x Depth x High (inch)	Wide x Depth x High (mm)	Nett	Gross
LP400HD	16.14x6.30x3.20	410x160x80	1.200	1.500

Complete with Metal Hose & Coupler



WARNING ▲  
Always wear  
safety goggles

USA

BELT WRENCH



Professional Tools

Just Provide Best Quality In The Class

Manufactured from high alloy steel quality with special heat treatment processing for better durability



Made by Better thickness belt provide more durability

Chrome Plated

BELT WRENCH

Product Number	Max Dia. (inch)	Length (inch)	Weight (gr)
WS006	6"	9"	350
WS011	8"	11"	500

ASME B107.400



WARNING ▲ Always wear safety goggles

SAFETY NOTICE :

Always pull the wrench handle. DON'T USE the HANDLE as PRY. Discard any wrench with bent handle or broken housing.



Manufactured from  
Nylon Coated Blade

Metric & inches reading

Comfort grip design



Easy to lock  
3 Locking Point

Better thickness blade  
Provide 2 times longer life & high stand out

### MEASURING TAPE

Product Number	Blade Width (mm)	Blade Length (mm)	Weight (gr)
M0003	16	3	120
M0005	19	5	200
MF005*	19	5	200
M0008	25	8	370
M0010	25	10	490

\*Fengshui Information



WARNING ▲  
Always wear  
safety goggles

**SAFETY NOTICE :**

ALWAYS USE SAFETY GOGGLES to PROTECT YOUR EYES from TAPE BLADE.



**MULTI PURPOSE PLIER**

P/N	Description	Weight (gr)
TA15A-1001-U150	15 Multi Function Stainless Steel Plier 6" with Nylon Pouch	90

ANSI Standard

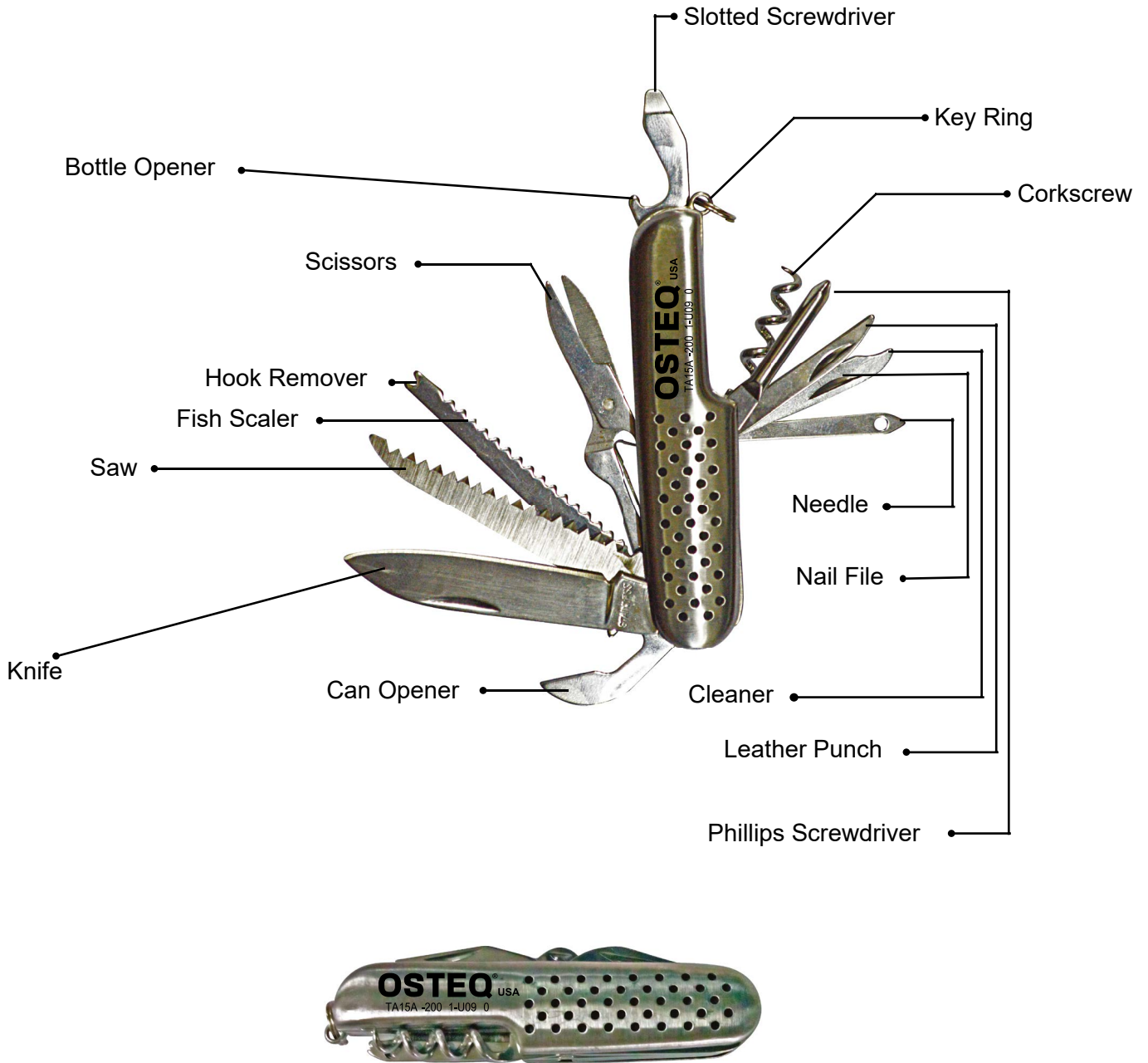

**MULTI FUNCTION POCKET KNIFE**

P/N	Description	Weight (gr)
TA15A-2001-U090	15 Multi Function Stainless Steel Knife 6" with Nylon Pouch	118

ANSI Standard

## HSS Drill, DIN 338, 118 Split Point, Fully Ground, Tin Coating



Product Number	(D) Dia.	Dec. Equiv.	(F) Flute Length	(L) OAL
TC01A-0101-M01.00	1	0.0394	12	34
TC01A-0101-M01.50	1.5	0.0591	18	40
TC01A-0101-M02.00	2	0.0787	24	49
TC01A-0101-M02.50	2.5	0.0984	30	57
TC01A-0101-M03.00	3	0.1181	33	61
TC01A-0101-M03.50	3.5	0.1378	39	70
TC01A-0101-M04.00	4	0.1575	43	75
TC01A-0101-M04.50	4.5	0.1772	47	80
TC01A-0101-M05.00	5	0.1969	52	86
TC01A-0101-M05.50	5.5	0.2165	57	93
TC01A-0101-M06.00	6	0.2362	57	93
TC01A-0101-M06.50	6.5	0.2559	63	101
TC01A-0101-M07.00	7	0.2756	69	109
TC01A-0101-M07.50	7.5	0.2953	69	109
TC01A-0101-M08.00	8	0.3150	75	117
TC01A-0101-M08.50	8.5	0.3346	75	117
TC01A-0101-M09.00	9	0.3543	81	125
TC01A-0101-M09.50	9.5	0.3740	81	125
TC01A-0101-M10.00	10	0.3937	87	133
TC01A-0101-M10.50	10.5	0.4134	87	133
TC01A-0101-M11.00	11	0.4331	94	142
TC01A-0101-M11.50	11.5	0.4528	94	142
TC01A-0101-M12.00	12	0.4724	101	151
TC01A-0101-M12.50	12.5	0.4921	101	151
TC01A-0101-M13.00	13	0.5118	101	151

DIN 338

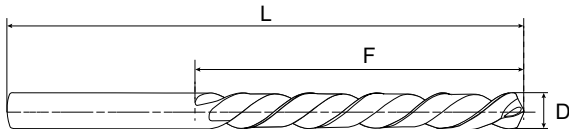

## HSS Tin Coating Drills Set DIN 338, 118 Split Point

Product Number	Sizes	Qty
TC00B-0000-U00019	1.0 - 10.0mm x 0.5mm	19 Ea
TC00B-0000-U00025	1.0 - 13.0mm x 0.5mm	25 Ea

**File Terminology**

**COURSENESS**

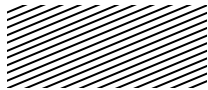

Bastard Cut

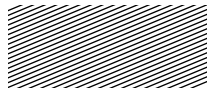

Second Cut

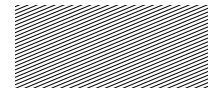

Smooth Cut

- Work to be accomplished, whether roughing or finishing, will determine type of teeth and coarseness for each application
- Most American pattern files are available with 3 grades of cut: bastard-cut, second-cut and smooth-cut
- The degree of coarseness is greater in longer files, but differences between bastard, second and smooth are proportionate

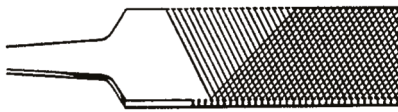

- 2 sets of diagonal rows of teeth
- Second set of teeth cut in opposite diagonal direction and on top of the first set
- First set of teeth is known as the overcut, second is known as upcut
- Upcut is finer than overcut
- Double-cut file is used with heavier pressure than the single-cut and removes material faster from the workpiece

**STEEL FILE FLAT POINTED**



**STEEL FILE HALF ROUND**

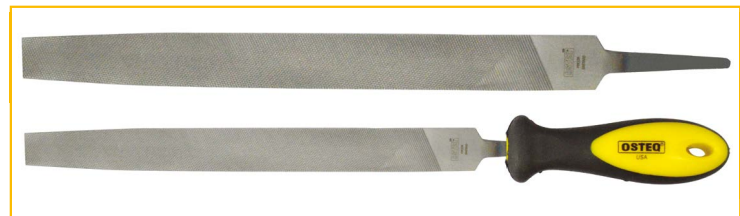

Product Number	Description	Overall Length		Weight (gr)
		inch	mm	
F0210A	Steel File Flat Pointed Bastard	10	250	225.00
F0210B	Steel File Flat Pointed Second	10	250	225.00
F0210C	Steel File Flat Pointed Smooth	10	250	225.00
F0210AH	Steel File Flat Pointed Bastard w/ Handle	15.35	390	291.31
F0210BH	Steel File Flat Pointed Second w/ Handle	15.35	390	291.31
F0210CH	Steel File Flat Pointed Smooth w/ Handle	15.35	390	291.31

Product Number	Description	Overall Length		Weight (gr)
		inch	mm	
F0510A	Steel File Half Round Bastard	10	250	225.00
F0510B	Steel File Half Round Second	10	250	225.00
F0510C	Steel File Half Round Smooth	10	250	225.00
F0510AH	Steel File Half Round Bastard w/ Handle	15	380	291.31
F0510BH	Steel File Half Round Second w/ Handle	15	380	291.31
F0510CH	Steel File Half Round Smooth w/ Handle	15	380	291.31

## STEEL FILE FLAT POINTED

Product Number	Description	Overall Length		Weight (gr)
		inch	mm	
F0210A	Steel File Flat Pointed Bastard	10	250	225.00
F0210B	Steel File Flat Pointed Second	10	250	225.00
F0210C	Steel File Flat Pointed Smooth	10	250	225.00
F0210AH	Steel File Flat Pointed Bastard w/ Handle	15.35	390	291.31
F0210BH	Steel File Flat Pointed Second w/ Handle	15.35	390	291.31
F0210CH	Steel File Flat Pointed Smooth w/ Handle	15.35	390	291.31



## STEEL FILE HALF ROUND

Product Number	Description	Overall Length		Weight (gr)
		inch	mm	
F0510A	Steel File Half Round Bastard	10	250	225.00
F0510B	Steel File Half Round Second	10	250	225.00
F0510C	Steel File Half Round Smooth	10	250	225.00
F0510AH	Steel File Half Round Bastard w/ Handle	15	380	291.31
F0510BH	Steel File Half Round Second w/ Handle	15	380	291.31
F0510CH	Steel File Half Round Smooth w/ Handle	15	380	291.31



## STEEL FILE TRIANGULAR

Product Number	Description	Overall Length		Weight (gr)
		inch	mm	
F0410A	Steel File Triangular Bastard	10	250	187.50
F0410B	Steel File Triangular Second	10	250	187.50
F0410C	Steel File Triangular Smooth	10	250	187.50
F0410AH	Steel File Triangular Bastard w/ Handle	15.35	390	253.81
F0410BH	Steel File Triangular Second w/ Handle	15.35	390	253.81
F0410CH	Steel File Triangular Smooth w/ Handle	15.35	390	253.81



## STEEL FILE ROUND

Product Number	Description	Overall Length		Weight (gr)
		inch	mm	
F0610A	Steel File Round Bastard	10	250	142.50
F0610B	Steel File Round Second	10	250	142.50
F0610C	Steel File Round Smooth	10	250	142.50
F0610AH	Steel File Round Bastard w/ Handle	15.15	385	208.81
F0610BH	Steel File Round Second w/ Handle	15.15	385	208.81
F0610CH	Steel File Round Smooth w/ Handle	15.15	385	208.81

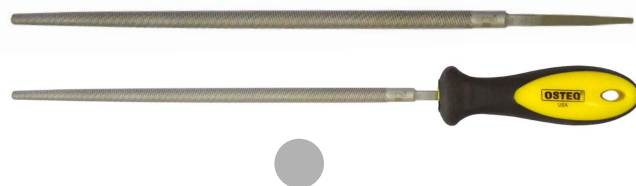

## STEEL FILE SQUARE

Product Number	Description	Overall Length		Weight (gr)
		inch	mm	
F0710A	Steel File Square Bastard	10	250	172.50
F0710B	Steel File Square Second	10	250	172.50
F0710C	Steel File Square Smooth	10	250	172.50
F0710AH	Steel File Square Bastard w/ Handle	15	380	238.81
F0710BH	Steel File Square Second w/ Handle	15	380	238.81
F0710CH	Steel File Square Smooth w/ Handle	15	380	238.81

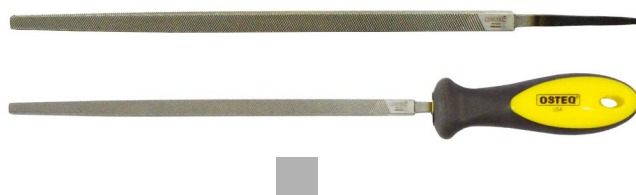

## FILE HANDLE

Product Number	Description	Hole	Overall Length		Weight (gr)
			inch	mm	
FHD001	Handle for Flat & Half Round File	■	5	120	66.31
FHD002	Handle for Triangular, Round & Square File	●	5	120	66.31



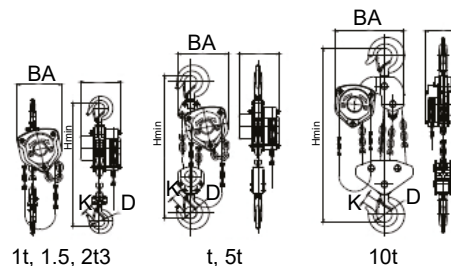

## CHAIN HOIST

Model		TG10A-1003-U010	TG10A-1003-U015	TG10A-1003-U020	TG10A-1003-U030	TG10A-1003-U050	TG10A-1003-U100
Capacity	tons	1	1.5	2	3	5	10
Load Chain	mm	6x18	8x24	8x24	8x24	10x30	10x30
Strands Of Load Chain		1	1	1	2	2	4
Strands Lift	m	2.5	2.5	3	3	3	3
Moving Distance Of Load Wheel With One Meter Lifting	m	41.5	55.6	72.6	111.2	163.4	326.8
Effort Required To Lift Rated Load	N	320	360	365	385	435	435
Running Test Load	KN	12.25	18.38	24.5	36.75	61.25	122.5
Dimensions (mm)	A	148	170	170	170	190.4	190
	B	162	183	194	220	288	384
	Hmin	317	399	414	465	636	798
	D	40	45	50	58	64	85
	K	31	32.5	37	40	46	50
Extra Weight Per Metre Of Extra Lift	kg	1.6	2.2	2.2	3.6	5.2	9.5
Net Weight	kg	11	15.6	18.3	24.6	39	78.4

\* Designed according & meets to EN 13157 Standard

\* Steel alloy chain, grade 80 according to ISO 3077 Standard

\* 360 degree handle rotation with short stroke to ratchet loads

\* Spur gear efficiency reduces operator effort

\* Double pawl and double guide rollers enhance performance, safety, and reliability

\* Equipped with wide throat top and bottom drop forged hooks that are designed to bend slowly warn of overloads

\* Covered by accident insurance up to USD 2.000.000

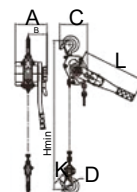

3/4t, 1t, 1.5t, 2t, 3t

## LEVER HOIST

Model		TG10A-2001-U008	TG10A-2001-U010	TG10A-2001-U015	TG10A-2001-U020	TG10A-2001-U030
Capacity	tons	3/4	1	1.5	2	3
Load Chain	mm	6x18	6x18	8x24	8X24	10X30
Strands Of Load Chain		1	1	1	1	1
Strands Lift	m	1.5	1.5	1.5	1.5	1.5
Load Chain Distance By Rotating The Hand Wheel One Circle	mm	19.8	19.8	21.3	21.3	16.8
Effort Required To Lift Rated Load	N	270	360	295	393	335
Running Test Load	KN	9.2	12.25	18.4	24.5	36.8
Dimensions (mm)	A	148	148	176	176	195
	B	55	55	102	102	109
	C	135	135	162	162	211
	D	37	35.5	45	42.5	50
	Hmin	320	320	380	380	480
	L	290	290	420	420	420
	K	26	26	32.5	32	37
Extra Weight Per Metre Of Extra Lift	kg	0.8	0.8	1.4	1.4	2.2
Net Weight	kg	7.9	8.7	10.9	14.3	20.3

\* Designed according & meets to EN 13157 Standard

\* Steel alloy chain, grade 80 according to ISO 3077 Standard

\* 360 degree handle rotation with short stroke to ratchet loads

\* Spur gear efficiency reduces operator effort

\* Double pawl and double guide rollers enhance performance, safety, and reliability

\* Equipped with wide throat top and bottom drop forged hooks that are designed to bend slowly warn of overloads

\* Covered by accident insurance up to USD 2.000.000



**CANVAS BAG**

Product Number	Dimension		Weight / gr
	Wide x Depth x High (inch)	Wide x Depth x High (mm)	
TA02A-5001-U019	19.00x7.00x6.30	480x180x160	650
TA02A-5001-U026	26.00x7.50x7.00	650x190x180	1.150



**PORTABLE TOOLBOX 19" with Socket Tray**

Product Number	Dimension		Weight / gr	
	Wide x Depth x High (inch)	Wide x Depth x High (mm)	Nett	Gross
T9296	19.00x6.25x3.80	483x159x96.50	1.800	2.000



**PORTABLE TOOLBOX with Tray**

Product Number	Dimension		Weight / gr	
	Wide x Depth x High (inch)	Wide x Depth x High (mm)	Nett	Gross
T9217	16.90x7.00x7.50	430x177x190	3.000	3.200
T9220	20.00x8.60x9.50	508x218x241	5.000	5.200



**PORTABLE TOOLBOX with Tray & Side Handle**

Product Number	Dimension		Weight / gr	
	Wide x Depth x High (inch)	Wide x Depth x High (mm)	Nett	Gross
T9220SH	20.00x8.60x9.50	508x218x241	5.200	5.500
T9224SH	24.10x8.60x9.50	612x218x243	8.000	8.200
T9226SH	26.40x8.60x9.50	670x218x241	8.700	9.000

**HEAVY DUTY CANTILEVER TOOLBOX 19.5"**  
**with 5 Tray & Double Handle**

Product Number	Dimension		Weight / gr	
	Wide x Depth x High (inch)	Wide x Depth x High (mm)	Nett	Gross
T9960	19.50x7.90x11.40	495x200x290	5.800	6.000

**HEAVY DUTY CANTILEVER TOOLBOX 21.5"**  
**with 5 Tray & Single Handle**

Product Number	Dimension		Weight / gr	
	Wide x Depth x High (inch)	Wide x Depth x High (mm)	Nett	Gross
T9961	21.50x7.90x8.20	580x220x250	5.800	6.120

**3 DOOR LOCKABLE WALL CABINET**

Product Number	Dimension		Weight / gr	
	Wide x Depth x High (inch)	Wide x Depth x High (mm)	Nett	Gross
T9103	47.20x7.90x23.60	1.200x200x600	18.500	19.000

**TOP CHEST 6 DRAWER**  
**with Smooth Action Slide Cabinet**

Product Number	Dimension		Weight / gr	
	Wide x Depth x High (inch)	Wide x Depth x High (mm)	Nett	Gross
T9406	26.30x12.40x15.20	668x316x386	20.000	22.000





### ROLLER CABINET 5 DRAWER with Smooth Action Slide Cabinet

Product Number	Dimension				Weight / gr	
	Wide x Depth x High (mm)	High With Roller (mm)	Cubic (mm)	Drawer Bearings	Nett	Gross
T9305	688x458x850	855	16,660	Yes	42.500	45.000

Drawer Dimensions	Width (mm)	Depth (mm)	Height (mm)
4 Drawers	615	430	105
1 Drawer	615	430	210



### ROLLER CABINET 7 DRAWER with Heavy Duty Side Handle

Product Number	Dimension				Weight / gr	
	Wide x Depth x High (mm)	High With Roller (mm)	Cubic (mm)	Drawer Bearings	Nett	Gross
T9307	688x475x858	1018	141,372	No	54.000	57.300

Drawer Dimensions	Width (mm)	Depth (mm)	Height (mm)
5 Drawers	440	595	77
2 Drawers	440	595	155



### METAL WORK BENCH with 2 & 3 DRAWER

Product Number	Dimension		Weight / gr	
	Wide x Depth x High (inch)	Wide x Depth x High (mm)	Nett	Gross
TWB150	59.0x25.5x34	1.500x640x865	63.000	69.000
TWB200	78.7x25.5x34	2.000x640x865	82.000	89.000



### METAL WORK BENCH with 2 & 3 DRAWER & TOOL PANEL

Product Number	Dimension		Weight / gr	
	Wide x Depth x High (inch)	Wide x Depth x High (mm)	Nett	Gross
TWB150P	59.0x25.5x61	1.500x640x1.550	83.000	89.000
TWB200P	78.7x25.5x61	2.000x640x1.550	105.000	112.000

**SINGLE WIRE HOOK**

Product Number	Description	Overall Length (Wide x Depth x High)		Weight (gr)
		Inch	mm	
TA02A-6090-U150	Single Wire Hook L150	6	150	29
TA02A-6090-U100	Single Wire Hook L100	4	100	25
TA02A-6090-U050	Single Wire Hook L50	2	50	24



**SHELF**

Product Number	Description	Overall Length (Wide x Depth x High)		Weight (gr)
		Inch	mm	
TA02A-6080-U035	Racking Display Shelf	35*14	90*35	-
TA02A-6080-U045	Racking Display Shelf	35*18	90*45	3750
TA02A-6081-U030	Racking Display Shelf	39*12	100*30	-
TA02A-6081-U035	Racking Display Shelf	39*14	100*35	3300
TA02A-6082-U035	Racking Display Shelf	40*14	103*35	3050
TA02A-6082-U045	Racking Display Shelf	40*18	103*45	4200



**RACKING DISPLAY**

Product Number	Description	Specification (Wide x Depth x High)		Weight (gr)
		Inch	mm	
TA02A-6002-U197	Racking Display	40*18*77	103*45*197	43.560
TA02A-6002-U237	Racking Display	40*18*93	103*45*237	47.660

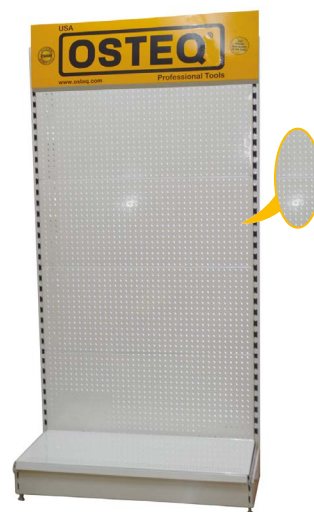

**RACKING DISPLAY ROLLER**

Product Number	Description	Specification (Wide x Depth x High)		Weight (gr)
		Inch	mm	
TA02A-6020-U180	Racking Roller Display Two Side	39*27*71	100*70*180	50.926

